



Series 354W00 DIP to SOWIC Adapters

FEATURES:

- Convenient, cost-effective means of converting DIP style packaging to SOWIC PC board layouts.

SPECIFICATIONS:

- Socket body is black, UL 94V-0 Glass-filled 4/6 Nylon 170°C. continuous use temp.
- PCB is FR-4, .062 [1.58] thick.
- Male adapter pin is Brass Alloy 360 1/2 hard per UNS C36000 ASTM-B16-85.
- Male adapter pin plating is 200μ [5.08μm] min. Tin per MIL-T-10727 Type 1 or Tin/Lead 90/10 MIL-P-81728 over 100μ [2.54μm] Nickel per QQ-N-290.
- Collet contact pin body is Brass Alloy 360 1/2 hard per UNS C36000 ASTM-B16-85.
- Collet pin plating is 10μ [.254μm] min. Gold per MIL-G-45204 over 100μ [2.54μm] min. Nickel per QQ-N-290.
- 4-fingered collet contact is Beryllium Copper Alloy per UNS C17200 ASTM-B194-92.
- Contact plating is 10μ [.254μm] min. Gold per MIL-G-45204 over 50μ [1.27μm] min. Nickel per QQ-N-290.
- Contact current rating=3 Amps.
- Operating temperature=221°F [105°C].
- Insertion Force=180 grams/pin; Withdrawal Force=90 grams/pin; Normal Force=140 grams/pin; based on a .018 [.46] diameter test lead.
- Socket accepts leads .015-.025 [.38-.64] in diameter, .100-.125 [2.54-3.18] long.

MOUNTING CONSIDERATIONS:

- Suggested PCB solder pad size=.028 [.71] min. width.

NO PICTURE AVAILABLE AT THIS TIME

Note: Aries specializes in custom design and production. In addition to the standard products shown on this page, special materials, platings, sizes, and configurations can be furnished, depending on quantities. Aries reserves the right to change product specifications without notice.

ORDERING INFORMATION

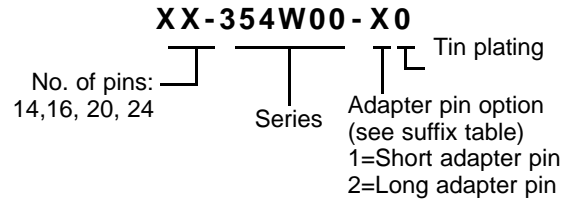

Part No. Suffix	Dim. "X"	Dim. "Y"
-10	.265 [6.73]	.050 [1.27]
-20	.325 [8.26]	.110 [2.79]

MALE ADAPTER PIN DETAIL

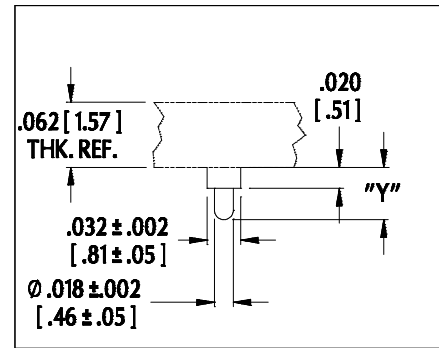

ALL DIMENSIONS: INCHES [MILLIMETERS]

All tolerances ± .005 [.13] unless otherwise specified

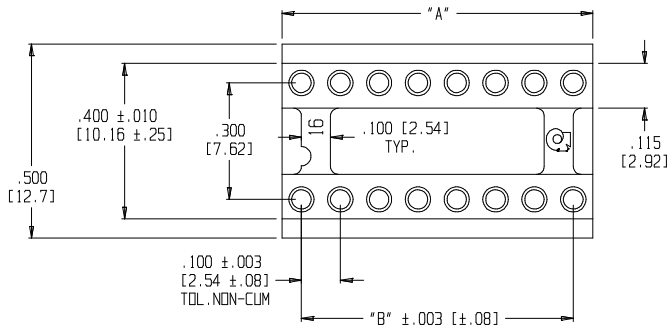

DIMENSION TABLE

Number of Pins	A	B	C	D
14	.7	.6	.3	.2
16	.8	.7	.35	.225
18	.9	.8	.4	.250
20	1.0	.9	.45	.275
24	1.2	1.1	.55	.325

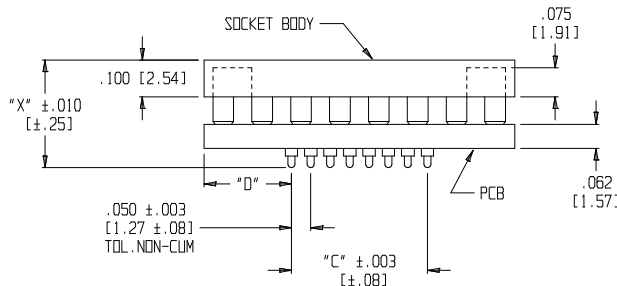

COLLET CONTACT DETAIL

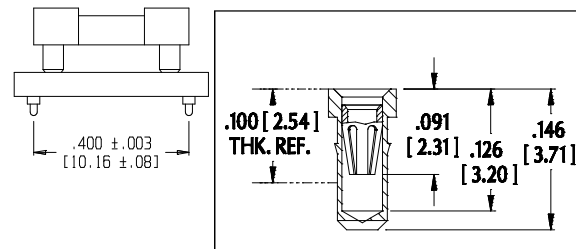

ARIES
ELECTRONICS, INC.
http://www.arieselec.com • info@arieselec.com

NORTH AMERICA
Frenchtown, NJ USA
TEL: (908) 996-6841
FAX: (908) 996-3891



EUROPE
TEL: +44 870 240 0249
FAX: +44 871 919 6033 18073
europe@arieselec.com REV.D